

Lightweight Gripping Systems SLG

Maximum dimensions: 350 x 350 x 250 mm

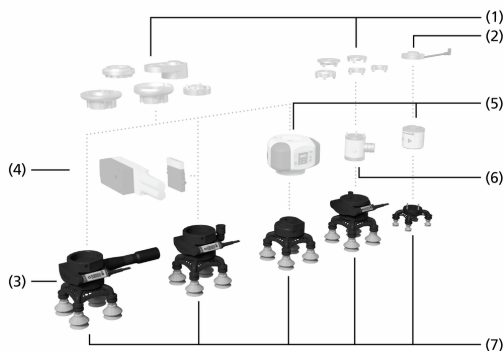

Lightweight Gripping Systems SLG



System design Lightweight Gripping Systems SLG

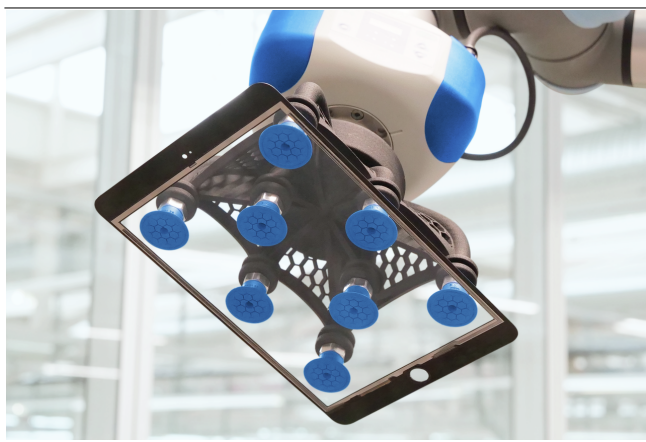

Lightweight gripper SLG with vacuum cups leaving few marks for handling display glass

Suitability for industry specific applications

Application

- Handling of freeform workpieces such as sheet metal and flat workpieces such as cardboard, pouches, etc.
- Ideal for pick-and-place applications with lightweight, Delta or SCARA robots
- End-of-line palletizing (EOLP)
- Removal of plastic parts from injection molding machines
- Thanks to its HRC-compatible design, it can be used in applications where people work near the handling system

Design

- Flange (1) or flange of the quick-change system MATCH (2) for connector to the robot
- Vacuum generator integrated in the gripper (3)
- External vacuum generation pneumatic (4) or electrical (5)
- Rotary union (6)
- Lightweight gripper SLG with various connection heads, depending on the vacuum generation used (7)

Product highlights

- Individual positioning of the suction cups on workpieces up to $L \times W = 350 \times 350$ mm
- Short procurement time thanks to automated design and production in batch size 1
- Quick and easy start of operations thanks to robot-specific flanges

Lightweight Gripping Systems SLG

Maximum dimensions: 350 x 350 x 250 mm

Ordering data Lightweight Gripping Systems SLG

Type	Part no.
SLG 141x111 X BALG 4	10.01.11.06583
SLG 199x111 X BALG 6	10.01.11.06584
SLG 219x179 X BALG 8	10.01.11.06585
SLG 141x111 M BALG 4	10.01.10.15124
SLG 199x111 M BALG 6	10.01.10.15125
SLG 219x176 M BALG 8	10.01.10.15126

Type	Part no.
SLG 102x57 FSGA 2	10.01.10.14043
SLG 102x102 FSGA 3	10.01.10.14042
SLG 102x75.3 FSGA 4	10.01.10.14041

Ordering data Spare parts Lightweight Gripping Systems SLG

Type	Spare parts	Part no.
SLG	X Ejector module	SEP HF 2 13 22 10.02.01.01347

Type	Spare parts	Part no.
SLG	M Vacuum/pressure switch	VSi V D M8-4 10.06.02.00577
SLG	X Vacuum/pressure switch	VSi V D M8-4 10.06.02.00577

Spare parts	Part no.
Bellows suction cups (round)	PSPF 43 SI-30/55 G1/4-AG 10.01.06.05597
Bellows suction cups (round)	SPB1 40 ED-65 G1/4-AG 10.01.06.03498
Bellows suction cups (round)	SPB2f 40 SI-55 G1/4-AG 10.01.06.03648
Bellows suction cups (round)	FSGA 20 NBR-55 G1/8-AG 10.01.06.00390

Ordering data Accessories Lightweight Gripping Systems SLG

Type	Accessories	Part no. FLAN-PL ECBPi	Part no. FLAN-PL UR-KUK-1
SLG	M Flange plate robot application	10.03.01.00379	10.03.01.00313
SLG	X Flange plate robot application	10.03.01.00379	10.03.01.00313

Lightweight Gripping Systems SLG

Maximum dimensions: 350 x 350 x 250 mm

Design data Lightweight Gripping Systems SLG

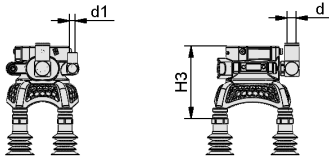
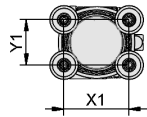

SLG M 4

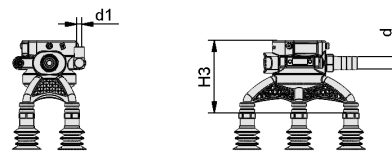
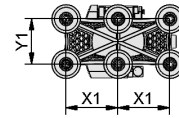

SLG M 6

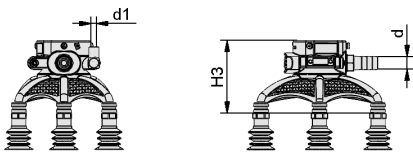
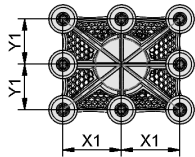

SLG M 8

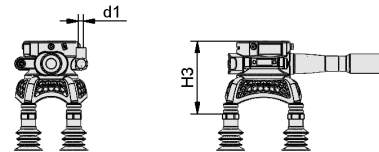
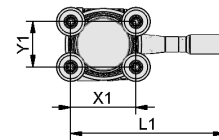

SLG X 4

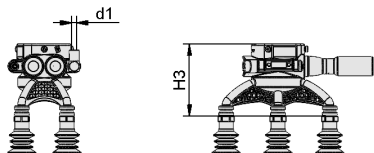
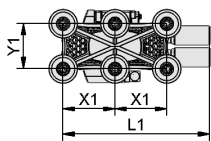

SLG X 6

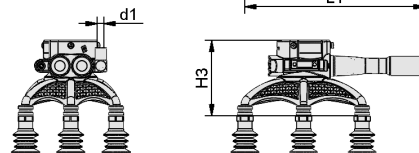
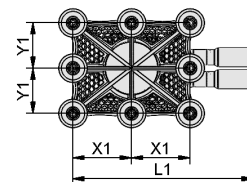

SLG X 8

Lightweight Gripping Systems SLG

Maximum dimensions: 350 x 350 x 250 mm

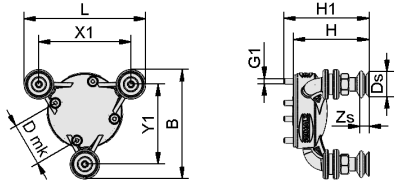

SLG 102x102

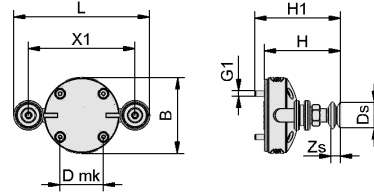

SLG 102x57 / 102x75.3

Lightweight Gripping Systems SLG

Maximum dimensions: 350 x 350 x 250 mm

Design data Lightweight Gripping Systems SLG

Type	d1 [mm]	H3 [mm]	L1 [mm]	X1 [mm]	Y1 [mm]
SLG 141x111 M BALG 4	8	109	-	98	68
SLG 199x111 M BALG 6	8	109	-	78	68
SLG 219x176 M BALG 8	8	109	-	88	68
SLG 141x111 X BALG 4	8	109	232	98	68
SLG 199x111 X BALG 6	8	109	221	78	68
SLG 219x179 X BALG 8	10	114	271	88	68

Type	B [mm]	Dmk [mm]	Ds [mm]	G1	H [mm]	H1 [mm]	L [mm]	X1 [mm]	Y1 [mm]	Zs [mm]
SLG 102x57 FSGA 2	57	46	17.2	M4-M	57	64.2	102	80	0.0	5
SLG 102x102 FSGA 3	102	46	17.2	M4-M	57	64.2	102	70	60.0	5
SLG 102x75.3 FSGA 4	76	46	17.2	M4-M	57	64.2	102	80	53.3	5

Multimedia product presentation

Medium	Link
Product video	https://vimeo.com/557188474 https://vimeo.com/408411459